

FLOOR PLAN #WC-A04

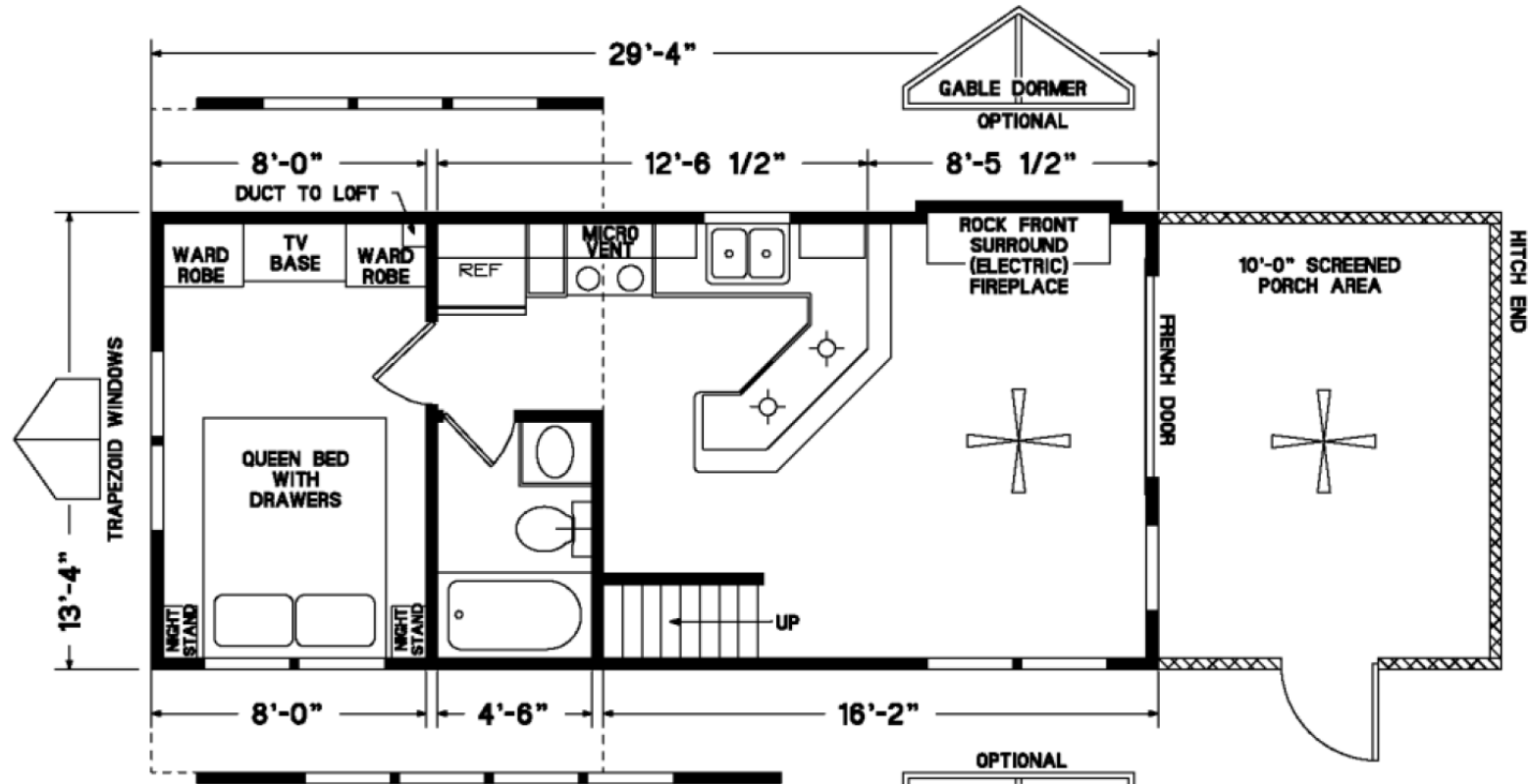

DETACHABLE HITCH
 10" I-BEAM FRAME W/TANDEM AXLES
 2X6 FLOOR JOIST 16" O.C.
 DOUBLE 2X6 PERIMETER FLOOR JOIST
 3/4 T&G OSB FLOOR DECKING
 2X4 EXTERIOR WALLS 16 O.C.
 CUSTOM BUILT 2X6 RAFTERS
 MOISTURE BARRIER VAPOR WRAP
 DOUBLE STUDS EVERY 4'-0"
 DOUBLE 2X6 HEADERS OVER WINDOWS AND DOORS
 TRIPLE STUDS AROUND WINDOWS & DOORS
 THERMO PANE WINDOWS AND DOORS
 PEX WATER LINES
 CUT OFF VALVES THROUGH OUT
 ELECTRICAL OUTLETS AND LIGHT FIXTURES
 CUSTOM HAND CRAFTED CEDAR CABINETS
 ROLLED COUNTERTOPS & ROLLED BACKSPASHES
 FOAM SEAL ON ALL EXTERIOR PLUGS & SWITCHES
 FOAM SEAL ON EVERY EXTERIOR STUD
 6 HURRICANE STRAPS (3 EACH SIDE)
 R-13 INSULATION IN WALLS
 R-22 INSULATION IN FLOOR
 R-19 INSULATION IN CEILING

LP SMART SIDE SIDING
 7'-0" SIDEWALLS
 9/12 ROOF PITCH
 10'-0" SCREENED PORCH AREA
 MINI BLIND FRENCH EXTERIOR DOORS
 EXTERIOR LIGHT AT DOOR
 EXTERIOR FAUCET
 12" OVERHANGS FRONT & REAR
 SHUTTERS (MATCHING ROOF COLOR)
 1/4 CEDAR PANELING
 LAMINATE FLOORING (VINYL FLOOR IN BATH)
 TRAPEZOID WINDOWS IN BEDROOM
 INTERIOR CEILING LIGHTS
 DUCTWORK TO LOFT AREA
 SMOKE ALARMS
 2-CEILING FANS
 REAL CEDAR TRIM THROUGH OUT
 100 AMP ELECTRICAL SERVICE
 NEC APPROVED ELECTRICAL WIRING
 OSB/TECH SHIELD RADIANT BARRIER ON ROOF
 15# FELT PAPER
 COLORED METAL (29 GAUGE)
 ELECTRIC FIREPLACE W/ROCK FRONT SURROUND

DOUBLE STAINLESS STEEL SINK IN KITCHEN
 WHITE 18 CUBIC FT. REFRIGERATOR
 WHITE 30" ELECTRIC RANGE
 WHITE MICROWAVE WITH RANGE HOOD COMBO
 54" 1 PIECE FIBERGLASS SHOWER W/CURTAIN
 PORCELAIN LAVATORY SINK IN BATH
 SINGLE LEVEL SERVING BAR TOP
 QUEEN BED WITH MATTRESS & DRAWERS
 20 GAL ELECTRIC WATER HEATER
 2" VINYL MINI BLINDS THROUGH OUT
 TV JACK IN LIVING ROOM & LOFT AREA
 TV DRESSER WITH TV JACK IN BEDROOM
 2-WARDROBES IN BEDROOM
 2-NIGHT STANDS IN BEDROOM
 1-3 WINDOW DORMERS OVER LOFT AREA
 1-4 WINDOW DORMERS OVER LOFT AREA
 40,000 BTU SUBURBAN GAS FURNACE
 1 TON COLEMAN A/C WITH PAD

VAULTED CEILING THROUGHOUT
 (EXCLUDING LOFT AREA)